

The Denver Metro Optometric Society

Cordially invites all members to a
Dinner and CE Meeting!

Wednesday, April 6, 2011

TLC (see attached directions)

Colorado Center

2000 South Colorado Blvd

Tower 1, 3rd Floor Conference Room

Denver, CO 80222

Dinner and meeting 6:20 PM – 7:00 PM

Two hours of CE* begins at 7:00 PM

Dinner and venue generously sponsored by



Speaker: Randy Craven, MD

“Glaucoma, What’s New?”

To RSVP, email DMOSRSVP@gmail.com
no later than Friday, April 1 at 3:00PM.

This event is open to DMOS members only. Not a member? Go to
www.visioncare.org/programs_information/local_societies.php to download an
application!

*Colorado-approved continuing education. You must be a COA member in good standing to
receive CE credit for this course.

Location Map & Directions

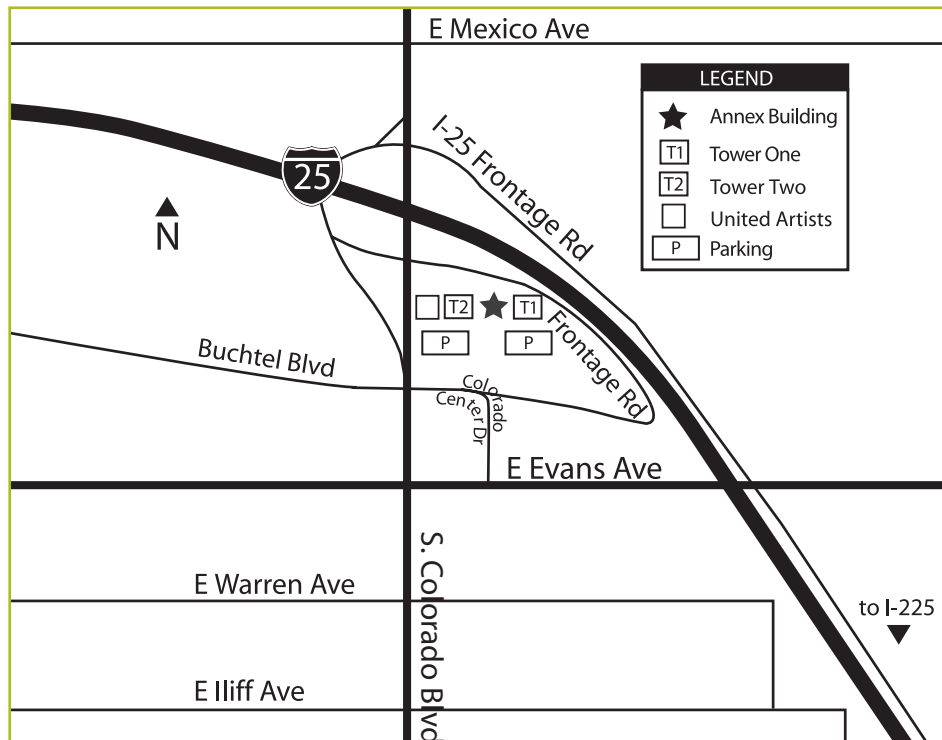

TLC Denver

2000 South Colorado Blvd
Annex Building, Suite 100
Denver, CO 80222

**DMOS meeting is in
Tower 1, 3rd Floor
Conference Room.**

From the North

Take I-25 South to Colorado Blvd (exit 204). At the light cross Colorado Blvd onto Frontage Road. Follow the Frontage Road to entrance into Colorado Center Annex Building on the right. Park in the east parking garage.

From the South

Take I-25 North to Evans Exit (exit 203). Turn left onto Evans (West) Turn right onto Colorado Center Drive (1st light). Take Colorado Center Drive straight to the second parking garage and 2000 So. Colorado Blvd.

Parking and Travel Tips to the DMOS meeting:

- There are multiple towers within the complex. Tower 1 is the main tower; however, it is actually located in the back of the complex and is not physically located on Colorado Blvd.
- The tower located directly next to the IMAX movie theater and Dave and Busters is actually Tower 2.
- Do not part in the parking garage just off Colorado Blvd! The correct parking garage is approximately 0.25 miles South of the Tower 1 parking garage, off of Colorado Center Drive. Follow the directions above to take you to the correct parking garage. Parking in the first floor visitor parking garage should be ample and a parking permit is not required.
- Starting at 5:30, a TLC representative will be in the main lobby of Tower 1 to provide directions and answer questions.
- Call Sean Sullivan at 720-244-9848 if you have trouble finding it.